

**GENERAL NOTES**

ALL DIMENSIONS IN MILLIMETRES

ALL LEVELS IN METRES

DO NOT SCALE FROM THIS DRAWING

REFER TO DRAWINGS 05G06/01/01-04

**CONSTRUCTION NOTES**

**CEMENT**

CEMENT TO BE SULPHATE RESISTING PORTLAND CEMENT TO BS 12:1978  
NO HIGH ALUMINA CEMENT TO BE USED.

**AGGREGATES**

ALL AGGREGATES FOR CONCRETE TO COMPLY WITH THE REQUIREMENTS OF BS 882:1983.  
NOMINAL MAXIMUM AGGREGATE SIZE 20mm.  
THE AGGREGATE CHLORIDE ION CONTENT OF THE AGGREGATE SHALL NOT EXCEED THE RECOMMENDATIONS FOR CHLORIDE CONTENT OF THE MIX, AS STATED IN BS B110 PART 1, CLAUSE 6.2.5.2 AND TABLE 6.4.

**WATER**

WATER, OTHER THAN MAINS SUPPLY, TO COMPLY WITH APPENDIX OF BS 3148.

**ADMIXTURES**

ADMIXTURES NOT TO BE USED  
NO CALCIUM CHLORIDE ADMIXTURES TO BE USED IN REINFORCED CONCRETE.

**REINFORCEMENT**

STEEL BAR REINFORCEMENT TO COMPLY WITH BS4449. STEEL FABRIC REINFORCEMENT IS TO COMPLY WITH BS 4483.  
REINFORCEMENT TO HAVE A MINIMUM COVER OF 35mm TO ALL SIDE UNLESS NOTED OTHERWISE.  
LAPS TO STEEL MESH REINFORCEMENT TO BE A MINIMUM OF 450mm IN ALL DIRECTIONS.  
ALL CUTTING AND BENDING TO BE CARRIED OUT IN ACCORDANCE WITH BS 4466.  
RODS TO BE BENT COLD IN A MANNER THAT WILL NOT INJURE THE METAL AND RODS SHOWING CRACKS OR BRITTLENESS SHALL BE REJECTED.  
ALL REINFORCEMENT TO BE FIXED RIGIDLY IN POSITION BY EXPERIENCED STEEL FIXERS, AND THE CONCRETE AND THE COVER SPECIFIED ON THE DRAWINGS AND IN THE NOTES TO CAREFULLY MAINTAINED.  
THE TYING WIRE IS TO BE THOROUGHLY ANNEALED No 16 SWG SOFT IRON WIRE AND TYING IS TO BE DONE TIGHTLY WITH PLIERS.  
REINFORCEMENT IS TO BE FULLY SUPPORTED ON CHAIRS WITH SPREADERS TO PREVENT DAMAGE TO THE DAMP PROOF MEMBRANE.

**FORMWORK**

THE DESIGN AND CONSTRUCTION OF THE FORMWORK TO BE IN ACCORDANCE WITH ITEM 6.9 OF BS 8110:PART 1.

**GENERAL**

CONCRETE TO BE USED IN THE WORKS TO BE PRESCRIBED MIXES FOR ORDINARY STRUCTURAL CONCRETE IN ACCORDANCE WITH THE REQUIREMENTS OF BS 5328:1981.  
CONCRETE: FLOOR SLAB TO BE GRADE C35, MINIMUM CEMENT CONTENT 300kg/m<sup>3</sup>. POWERFLOAT FINISH.  
CONCRETE: FOUNDATIONS TO BE GRADE C35, MINIMUM CEMENT CONTENT 300kg/m<sup>3</sup>. STEEL TROWEL FINISH.

**READY MIXED CONCRETE**

READY MIXED CONCRETE TO COMPLY WITH THE REQUIREMENTS OF THE SPECIFICATION AND BS 5328.  
READY MIXED CONCRETE TO BE SUPPLIED FROM QS/RMC APPROVED DEPOT.

**WORKABILITY**

THE WORKABILITY OF FRESH CONCRETE IS TO BE WITHIN THE LIMITS PERMITTED BY BS 5328.  
ALL STRUCTURAL CONCRETE TO BE THOROUGHLY COMPACTED BY VIBRATING POKER OR OTHER APPROVED MEANS TO ENSURE THAT TRAPPED AIR IS FREED AND THE CONCRETE COMPLETELY FILLS THE VOID OR FORMWORK. CONCRETE TO BE THOROUGHLY WORKED INTO CORNERS AND AROUND REINFORCEMENT.

**CURING**

CONCRETE TO BE PROTECTED DURING THE FIRST STAGE OF HARDENING FROM THE HARMFUL EFFECTS OF SUNSHINE, DRYING WINDS, COLD, RAIN OR RUNNING WATER. THE PROTECTION IS TO BE APPLIED AS SOON AS PRACTICABLE AFTER COMPLETION OF PLACING BY ONE OR MORE OF THE FOLLOWING METHODS.

1. THE CONCRETE MUST BE COVERED WITH A LAYER OF SACKING, CANVAS, HESSIAN, STRAW MATS OR SIMILAR ABSORBANT MATERIAL, OR A LAYER OF SAND, KEPT CONSTANTLY WET FOR SEVEN DAYS.
2. AFTER THOROUGHLY WETTING, THE CONCRETE SHALL BE COVERED WITH A LAYER OF APPROVED WATERPROOF PAPER OR PLASTIC MEMBRANE KEPT IN CONTACT WITH THE CONCRETE FOR SEVEN DAYS.
3. EXCEPT IN THE CASE OF SURFACES WHICH CONCRETE HAS SUBSEQUENTLY BONDED, THE CONCRETE MUST BE CURED BY APPLICATION OF AN APPROVED LIQUID CURING MEMBRANE. APPLICATION TO BE MADE BY LOW PRESSURE SPRAY TO THE MANUFACTURERS INSTRUCTIONS AND AT A RECOMMENDED RATE OF APPLICATION. ON HORIZONTAL SURFACES, THE CURING MEMBRANE MUST BE APPLIED IMMEDIATELY AFTER PLACING THE CONCRETE, AND ON VERTICAL SURFACES IMMEDIATELY AFTER REMOVING THE FORMWORK.

**GROUND CONDITIONS**

REQUIRED ALLOWABLE NETT GROUND BEARING PRESSURE = 50kN/m<sup>2</sup> UNDER NEW STRIP FOOTINGS. TO BE VERIFIED ON SITE.

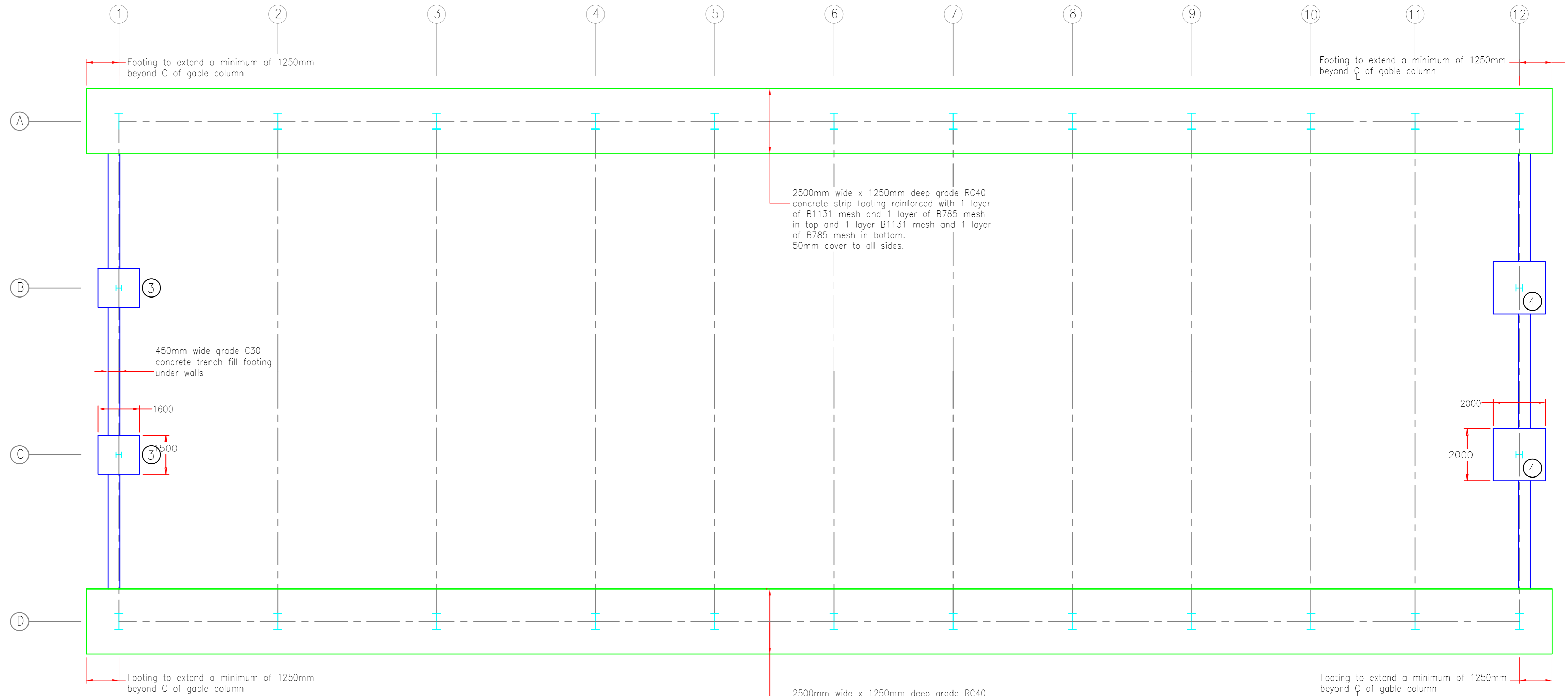

Foundation Layout (1:100)

Foundation type 3 to be 1500 x 1600 x 800mm thick - 2no.  
Foundation type 4 to be 2000 x 2000 x 1000mm thick - 2no.

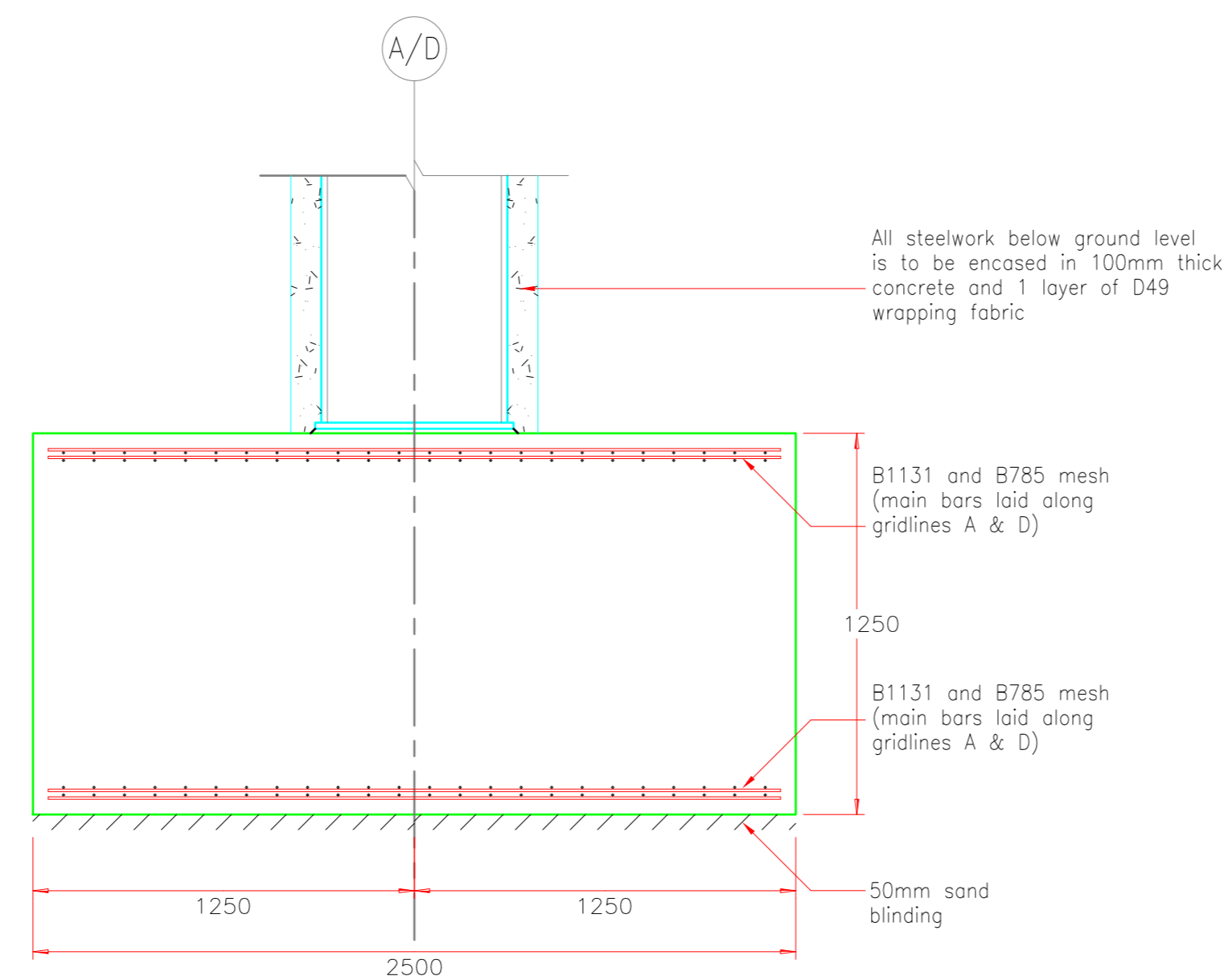

Section Through Reinforced Strip Footing (1:20)

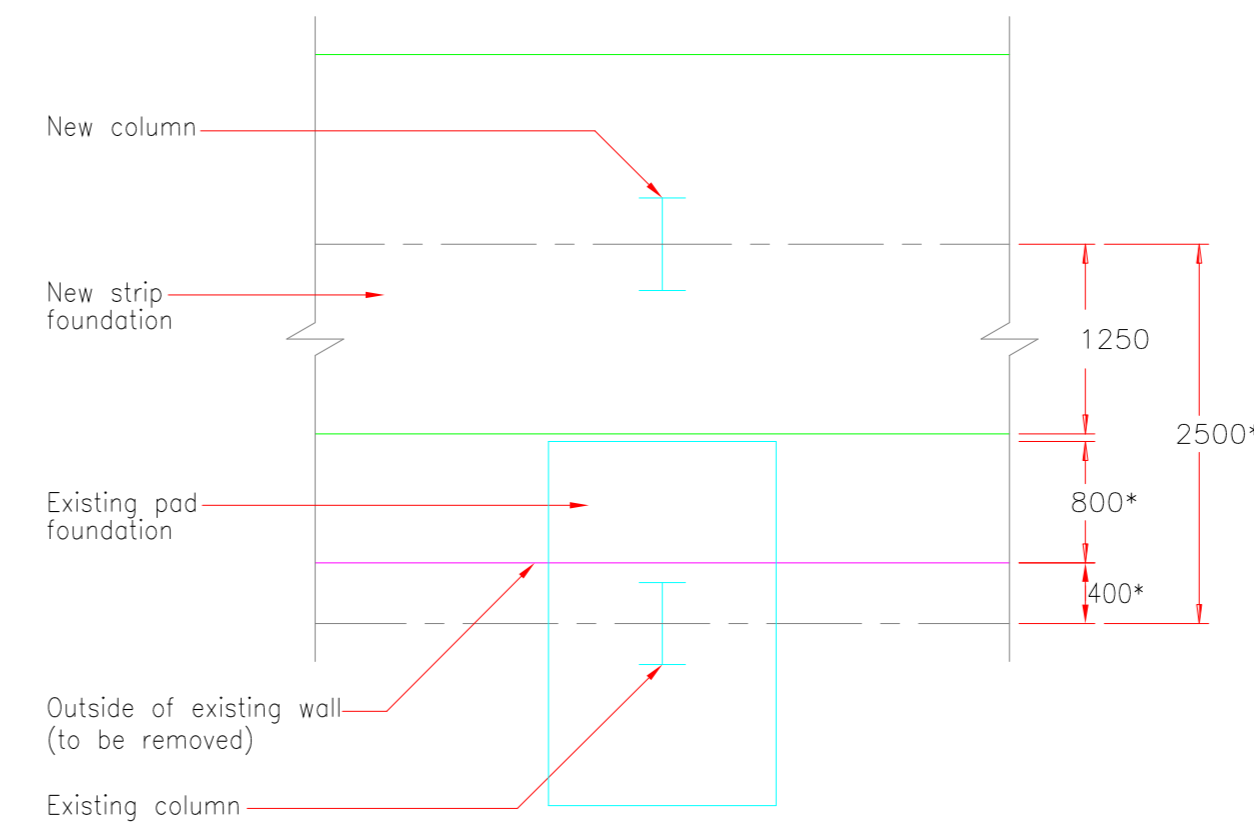

Plan on Gridline D (1:50)

All dimensions shown \* are approximate and must be verified on site

B	PAD FOUNDATIONS CHANGED TO REINFORCED STRIP FOOTINGS ON GRIDLINES A & D	06/05
A	FIRST ISSUE	02/05
REV	ISSUE	DATE

DRAWING STATUS	
<input type="radio"/> PRELIMINARY	<input type="radio"/> FOR TENDER
<input type="radio"/> FOR CLIENTS APPROVAL	<input type="radio"/> FOR CONSTRUCTION
<input type="radio"/> FOR BUILDING REGULATIONS/PLANNING	<input type="radio"/> AS BUILT

**ISA**  
4 The Pass Courtyard  
43 - 45 Market Street  
Ashby de la Zouch  
Leicestershire  
LE65 1AG  
Telephone 01530 560575  
Fax 01530 560557 © Copyright

CLIENT  
\*\*\*\*\*

PROJECT  
\*\*\*\*\*

TITLE  
FOUNDATION LAYOUT

DATE FEB 06	DRAWN NM	DRAWING NO 06G06/01/03	REV B
SCALE 1:100	CHECKED KS		